

SUZUKI 2011 TO PRESENT GSX1250FA & 2008-2010 GSX650F DIY WINDSCREEN INSTALL

Installation Instructions for 2011 to Present Suzuki GSX1250FA & 2008-2010 GSX650F

Thank you for purchasing a Zero Gravity windscreen, which has been designed and manufactured to give you years of safe & fun riding. These instructions will give you an in-depth look at the installation process. To receive further assistance or parts, please call Zero Gravity® Sales Department at 805-388-8803 or E-mail at salesinfo@zerogravity-racing.com.

PLEASE READ BEFORE MOUNTING YOUR WINDSCREEN

Helpful hints: Use metric tools, clean hands, put the bike on a stand. To avoid damage do not pry on the screen excessively.

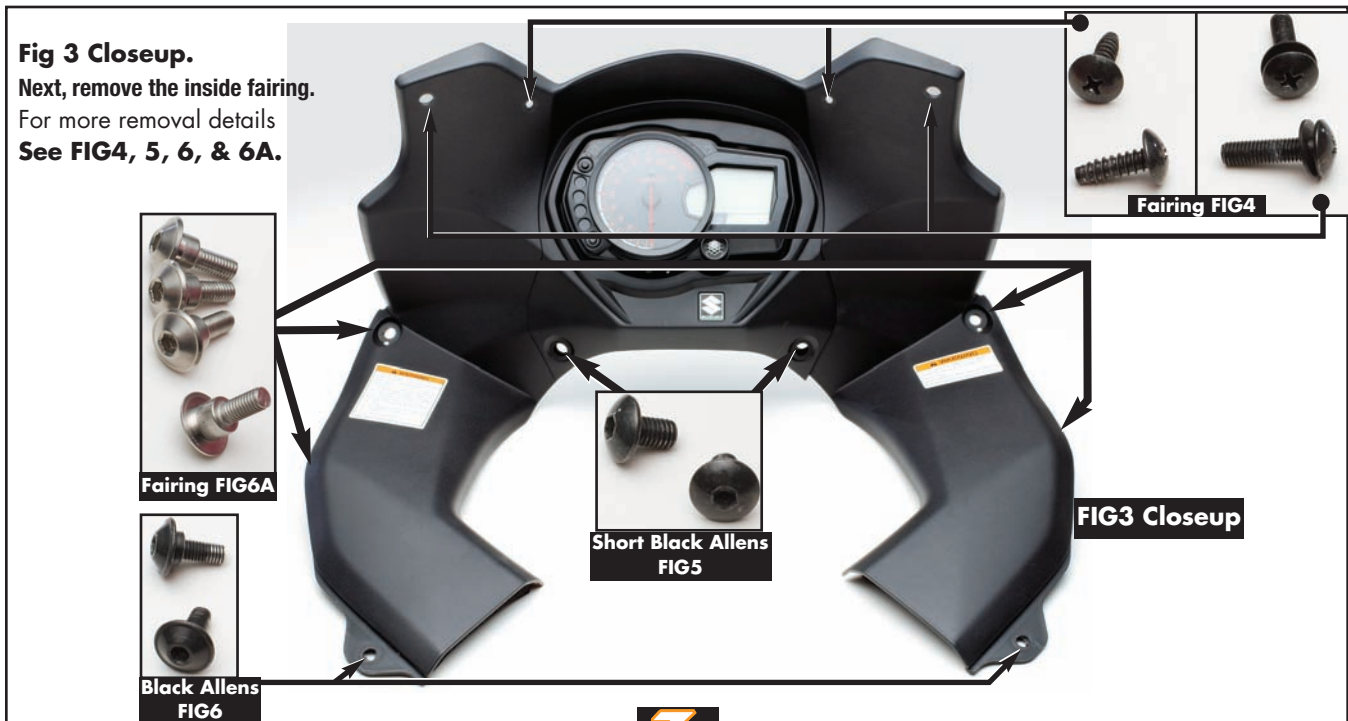
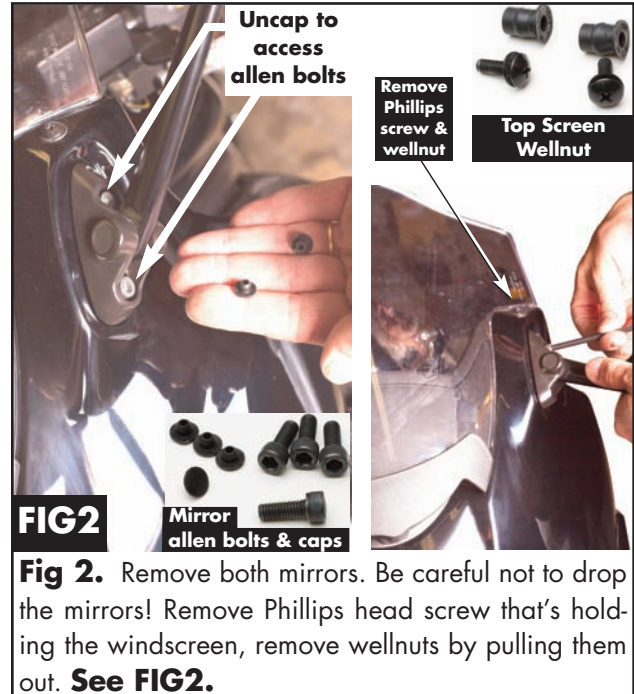
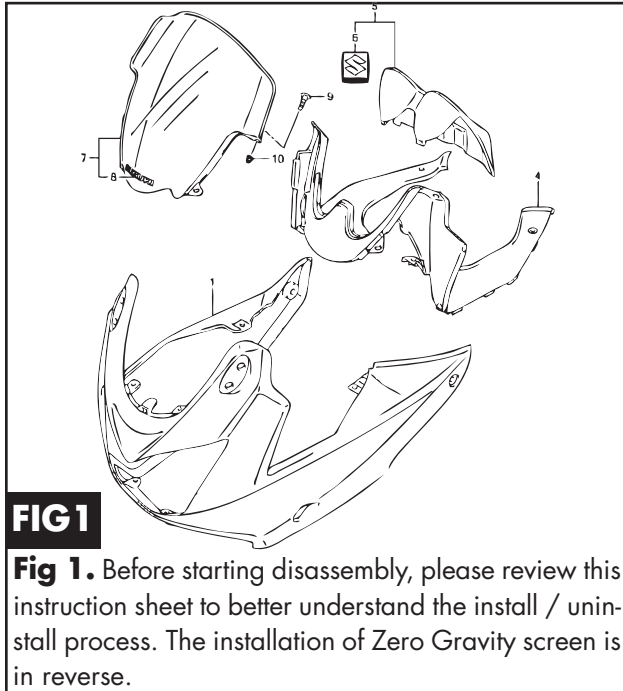

SUZUKI 2011 TO PRESENT GSX1250FA & 2008-2010 GSX650F DIY WINDSCREEN INSTALL



Fig 4. Looking from the upper inside fairing. Remove total of 4 screws, and take note of the different thread pitches. **(For Both Sides)**

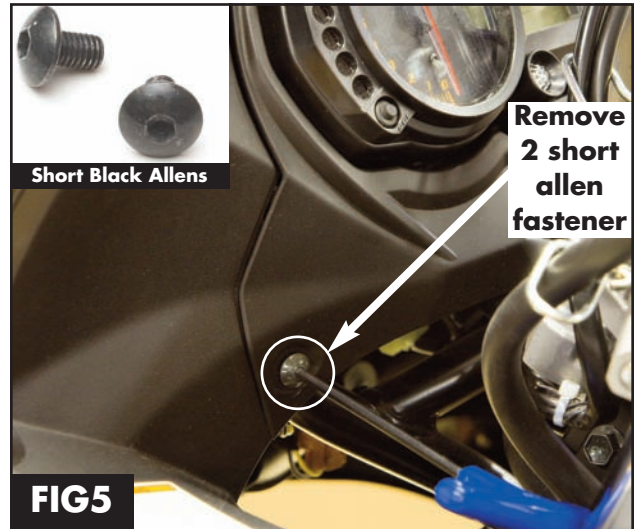

Fig 5. On the same plastic fairing, remove 2 black short allen fastener located on the bottom of the instrument cluster. **(For Both Sides) See FIG5.** Note: The finish allen screws are in Black.

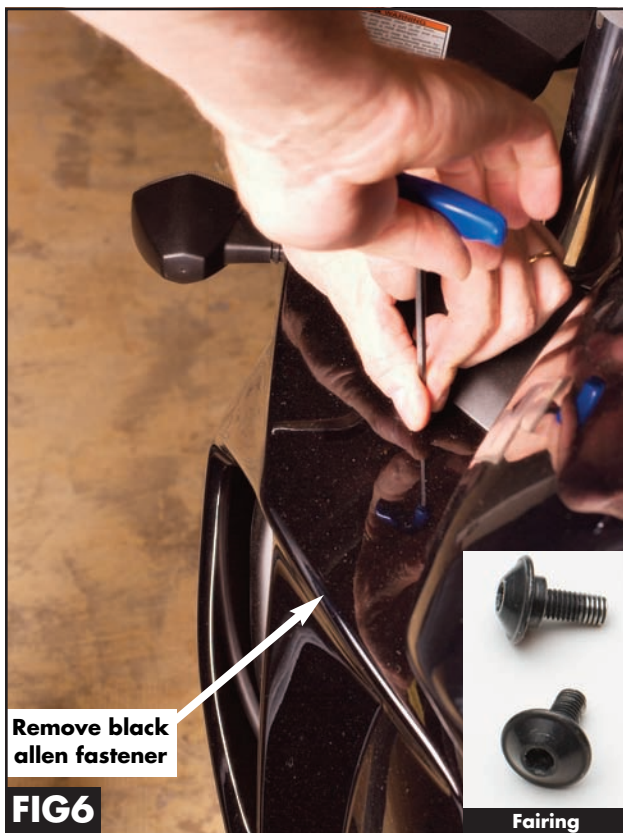

Fig 6. Remove 2 allen fastener closest to the tank. **(For Both Sides) See FIG6.** Note: The finish allen screws are in black.



Fig 6A. On the same plastic fairing, there are 4 silver allen fastener located on the top and the sides. **(For Both Sides)** Note: The finish allen screws are in Silver.

SUZUKI 2011 TO PRESENT GSX1250FA & 2008-2010 GSX650F DIY WINDSCREEN INSTALL



FIG7

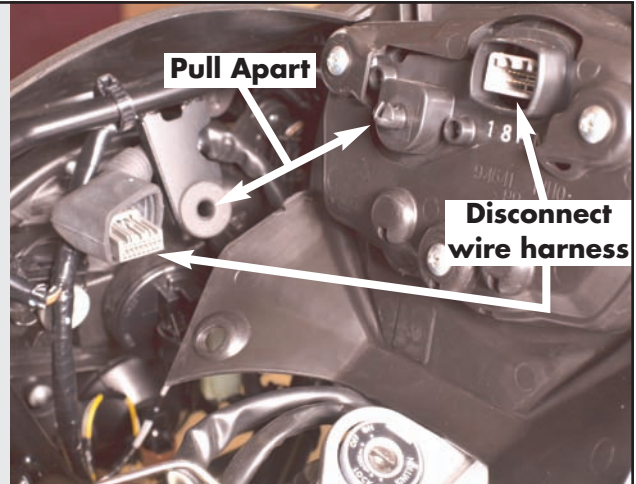
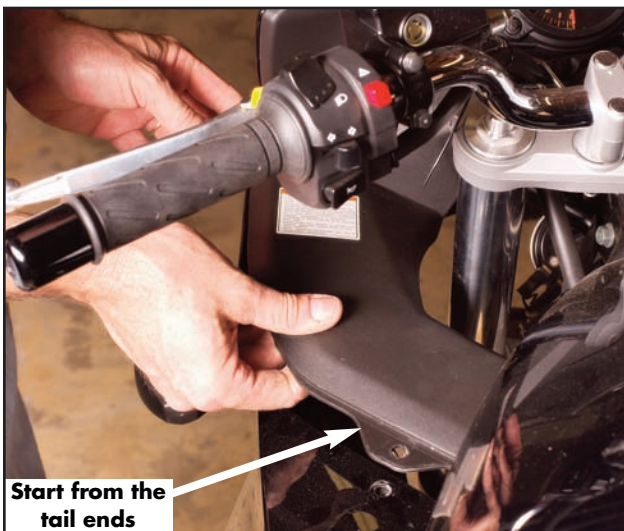

Fig 7. Remove instrument panel by pulling it apart from the fairing frame. The wire harness needs to be disconnected before fully removing. **USE CAUTION TO NOT OVER PULL!!!**



Start from the tail ends



FIG8

Work your way to the center.

Fig 8. Now you are ready to separate the inner fairing from the bike. Start from the two tail ends and start dislodging and working your way to the inside.



FIG 9

Bottom Wellnuts

Remove allen fastener

Fig 9. Remove 2 allen fastener at the bottom windscreen, viewing from the inside fairing. **(For Both Sides) See FIG9.**



FIG 9A

Wellnut

Remove wellnut

Fig 9A. After removing both allen fastener, remove the wellnut for easier screen removal. **(For Both Sides) See FIG9A.**

**SUZUKI 2011 TO PRESENT GSX1250FA & 2008-2010 GSX650F
DIY WINDSCREEN INSTALL**

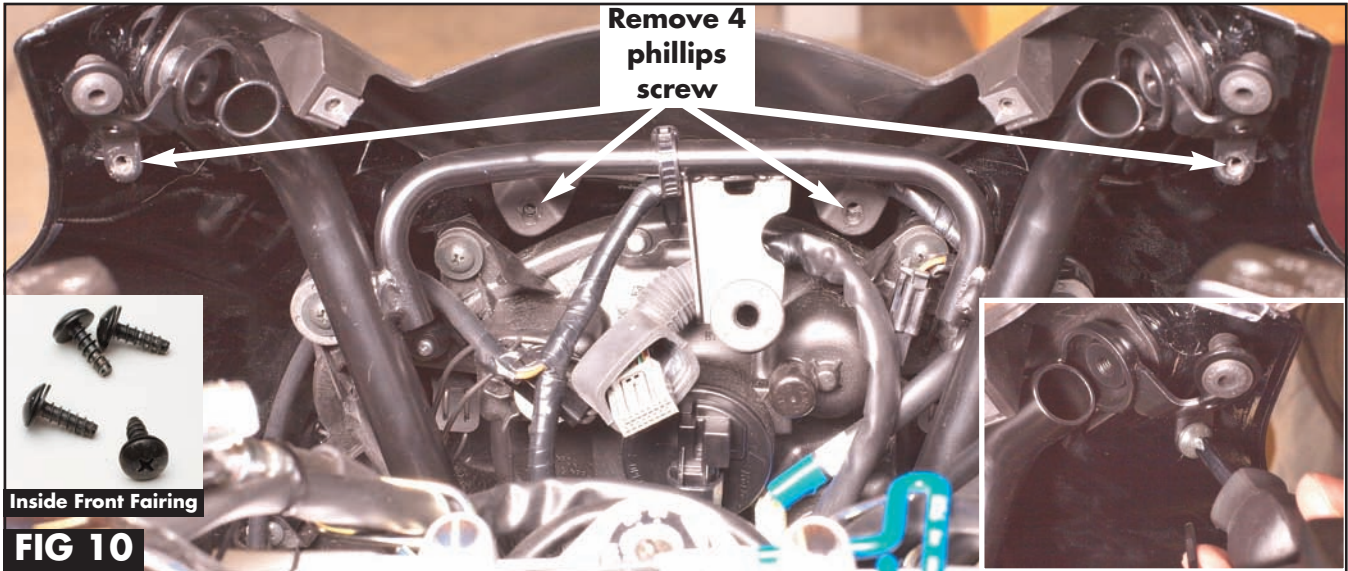

Inside Front Fairing

FIG 10

Fig 10. Remove all 4 phillips screw, located behind the inner fairing. **See FIG10.**



FIG 11

Fig 11. Prepare to remove windscreen. Hold the windscreen top and bottom as shown. First lift bottom of windscreen up towards you. While pulling top of screen towards the bike tank. **See FIG11.**
Be careful not to exert too much force!

SPORT TOURING



Fig 12. To Install Windscreen.

Replace windscreen in reverse steps.

Please see www.zerogravity-racing.com for further information concerning this product.